

STAND-ALONE INSTALLATION SUPPORT FOR
3RU21/3RB30/3RB31 SZ S00,
STAND-ALONE INSTALLATION MAIN CIRCUIT: SCREW
TERMINAL AUX. CIRCUIT: --

General technical data:

product brand name		SIRIUS
product designation		individual mount
Size of overload relay		S00
Ambient temperature		
• during storage	°C	-55 ... +80
• during operating	°C	-20 ... +70

Installation/mounting/dimensions:

Type of mounting		screw and snap-on mounting onto 35 mm standard mounting rail
Width	mm	45
Height	mm	86
Depth	mm	75

Connections:

Design of the electrical connection		
• for main current circuit		screw-type terminals
Type of the connectable conductor cross-section		
• for main contacts		
• solid		0.5 ... 4 mm ²

- finely stranded
- with conductor end processing
- for AWG conductors
- for main contacts

0.5 ... 2.5 mm²

1x (20 ... 12)

General Product Approval



Test Certificates

[Type Test
Certificates/Test
Report](#)

Shipping Approval



ABS

BUREAU
VERITAS

DNV

GL

LRS

Further information:

Information- and Downloadcenter (Catalogs, Brochures,...)

<http://www.siemens.com/industrial-controls/catalogs>

Industry Mall (Online ordering system)

<http://www.siemens.com/industrial-controls/mall>

CAX-Online-Generator

<http://www.siemens.com/cax>

Service&Support (Manuals, Certificates, Characteristics, FAQs,...)

<http://support.automation.siemens.com/WW/view/en/3RU2916-3AA01/all>

Image database (product images, 2D dimension drawings, 3D models, device circuit diagrams, ...)

http://www.automation.siemens.com/bilddb/cax_en.aspx?mlfb=3RU2916-3AA01

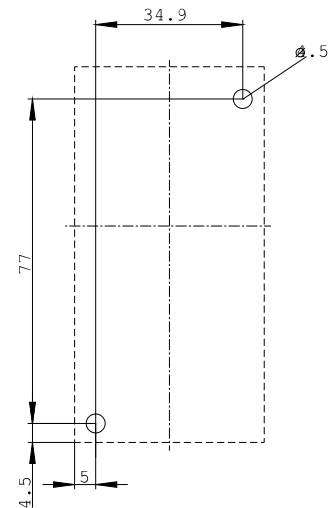
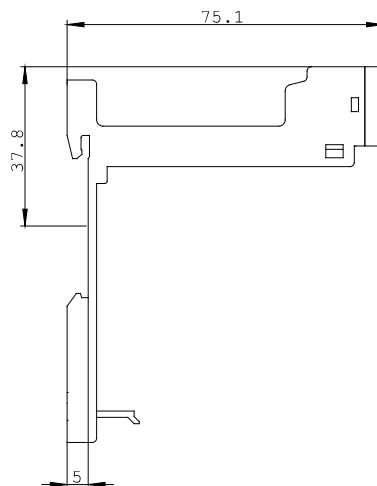
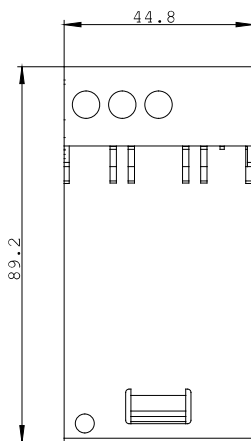

last change:

Apr 10, 2013