



OVERLOAD RELAY 0.32...1.25 A FOR MOTOR PROTECTION SIZE S00, CLASS 10 CONTACTOR ASS. MAIN CIRCUIT: SCREW CONN. AUX.CIRCUIT: SCREW CONN. MANUAL-AUTOM.-RESET

General technical data:		
product brand name		SIRIUS
product designation		solid-state overload relay
Size of overload relay		S00
Number of poles / for main current circuit		3
Product function / removable terminal for auxiliary and control circuit		Yes
Impulse voltage resistance / rated value	kV	6
Protection class IP / on the front		IP20
Protection against electrical shock		finger-safe
Installation altitude / at a height over sea level / maximum	m	2,000
Resistance against shock		15g / 11 ms
Ambient temperature		
• during transport	°C	-40 ... +80
• during storage	°C	-40 ... +80
• during operating	°C	-25 ... +60
Relative humidity		
• during operating phase	/ %	95
EMC immunity to interference		
• according to IEC 60947-1		corresponds to degree of severity 3

EMC emitted interference • according to IEC 60947-1		CISPR 11, environment B (residential area)
Electrostatic discharge • according to IEC 61000-4-2		6 kV contact discharge / 8 kV air discharge
Field-bound parasitic coupling • according to IEC 61000-4-3		10 V/m
Conductor-bound parasitic coupling BURST • according to IEC 61000-4-4		2 kV (power ports), 1 kV (signal ports) corresponds to degree of severity 3
Conductor-bound parasitic coupling conductor-earth SURGE • according to IEC 61000-4-5		2 kV (line to earth) corresponds to degree of severity 3
Conductor-bound parasitic coupling conductor-conductor SURGE • according to IEC 61000-4-5		1 kV (line to line) corresponds to degree of severity 3
type of protection		PTB 09 ATEX 3001 Ex II (2) GD
Size of the contactor / can be combined / company-specific		S00

Main circuit:

Operating current / of the fuse link / rated value	A	6
Operational current / at AC-3 / at 400 V / rated value	A	1.25
Type of assignment		2

Auxiliary circuit:

Number of NC contacts / for auxiliary contacts		1
Number of NO contacts / for auxiliary contacts		1
Number of changeover contacts / for auxiliary contacts		0
Design of the fuse link / for short-circuit protection of the auxiliary switch / required		fuse gL/gG: 6 A
Operating current / of the auxiliary contacts • at AC-15 • at 24 V • at 110 V • at 120 V • at 125 V • at 230 V • at DC-13 • at 24 V • at 60 V • at 110 V • at 125 V • at 220 V	A A A A A A A A A A A	4 4 4 4 3 2 1 0.3 0.3 1

Protection function:		
Trip class		CLASS 10
Adjustable response current		
<ul style="list-style-type: none"> of the current-dependent overload release 	A	0.32 ... 1.25

Installation/mounting/dimensions:		
Type of mounting		direct mounting
mounting position		any
Depth	mm	73
Height	mm	79
Width	mm	45

Connections:		
Design of the electrical connection		
<ul style="list-style-type: none"> for main current circuit 		screw-type terminals
<ul style="list-style-type: none"> for auxiliary and control current circuit 		screw-type terminals
Type of the connectable conductor cross-section		
<ul style="list-style-type: none"> for main contacts <ul style="list-style-type: none"> solid 		1x (0.5 ... 4 mm ²), 2x (0.5 ... 1.5 mm ²), 2x (0.75 ... 4 mm ²)
<ul style="list-style-type: none"> finely stranded <ul style="list-style-type: none"> with conductor end processing 		1x (0.5 ... 2.5 mm ²), 2x (0.5 ... 2.5 mm ²)
<ul style="list-style-type: none"> stranded 		1x (0.5 ... 1.5 mm ²), 2x (0.5 ... 1.5 mm ²), 1x (0.75 ... 4 mm ²), 2x (0.75 ... 4 mm ²)
<ul style="list-style-type: none"> for AWG conductors / for main contacts 		1x (20 ... 12), 2x (20 ... 12)
<ul style="list-style-type: none"> for auxiliary contacts <ul style="list-style-type: none"> solid 		1x (0.5 ... 4 mm ²), 2x (0.5 ... 1.5 mm ²), 2x (0.75 ... 2.5 mm ²)
<ul style="list-style-type: none"> finely stranded <ul style="list-style-type: none"> with conductor end processing 		1x (0.5 ... 1.5 mm ²), 2x (0.5 ... 1.5 mm ²), 1x (0.5 ... 2.5 mm ²)
<ul style="list-style-type: none"> for AWG conductors / for auxiliary contacts 		1x (20 ... 14), 2x (20 ... 14)

UL/CSA ratings:		
Contact rating designation / for auxiliary contacts / according to UL		B600 / R300

Certificates/approvals:

General Product Approval	EMC	For use in hazardous locations
---------------------------------	------------	---------------------------------------



CCC



CSA



GOST



UL



C-TICK



ATEX

Test Certificates

[Special Test Certificate](#)

[Type Test Certificates/Test Report](#)

Shipping Approval

other



ABS



BUREAU
VERITAS



GL



LRS



RMRS

[Declaration of Conformity](#)

Further information:

Information- and Downloadcenter (Catalogs, Brochures,...)

<http://www.siemens.com/industrial-controls/catalogs>

Industry Mall (Online ordering system)

<http://www.siemens.com/industrial-controls/mall>

Cax online generator:

<http://www.siemens.com/cax>

Service&Support (Manuals, Certificates, Characteristics, FAQs,...)

<http://support.automation.siemens.com/WW/view/en/3RB3016-1NB0/all>

Image database (product images, 2D dimension drawings, 3D models, device circuit diagrams, ...)

http://www.automation.siemens.com/bilddb/cax_en.aspx?mlfb=3RB3016-1NB0

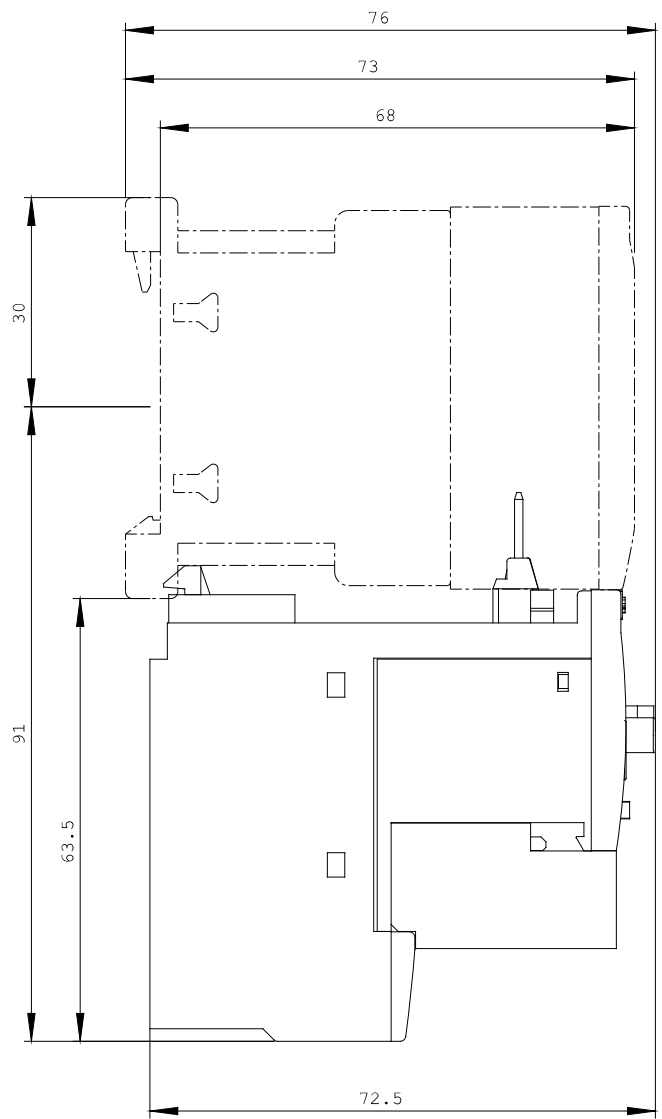
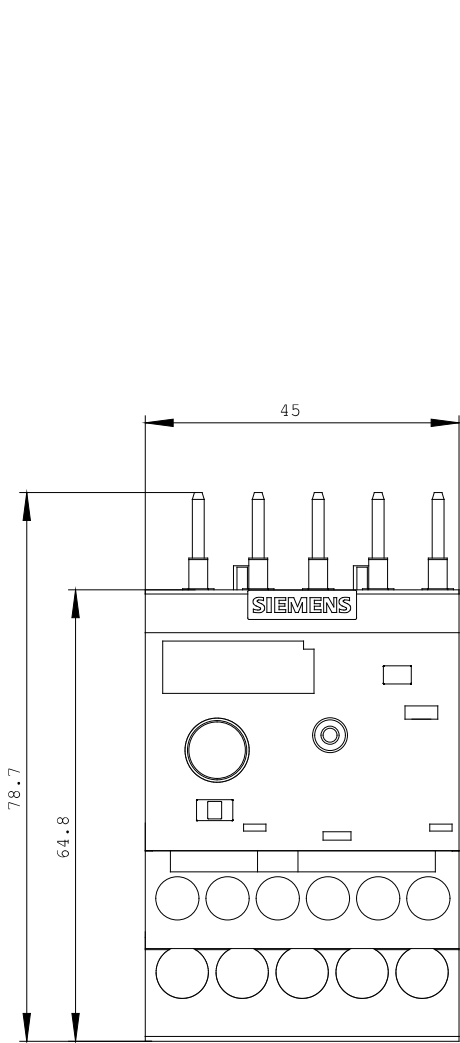

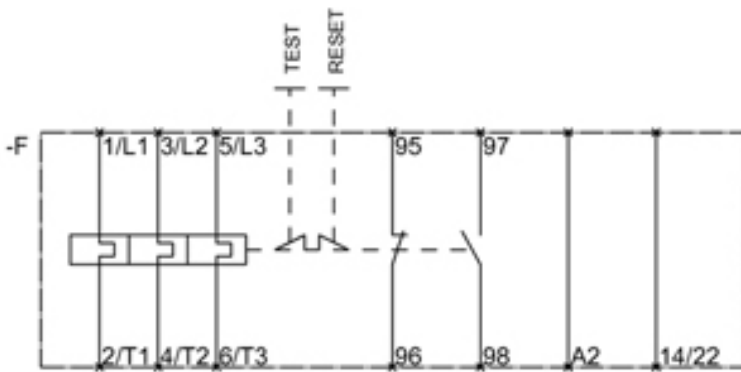

last change:

Jul 1, 2013